

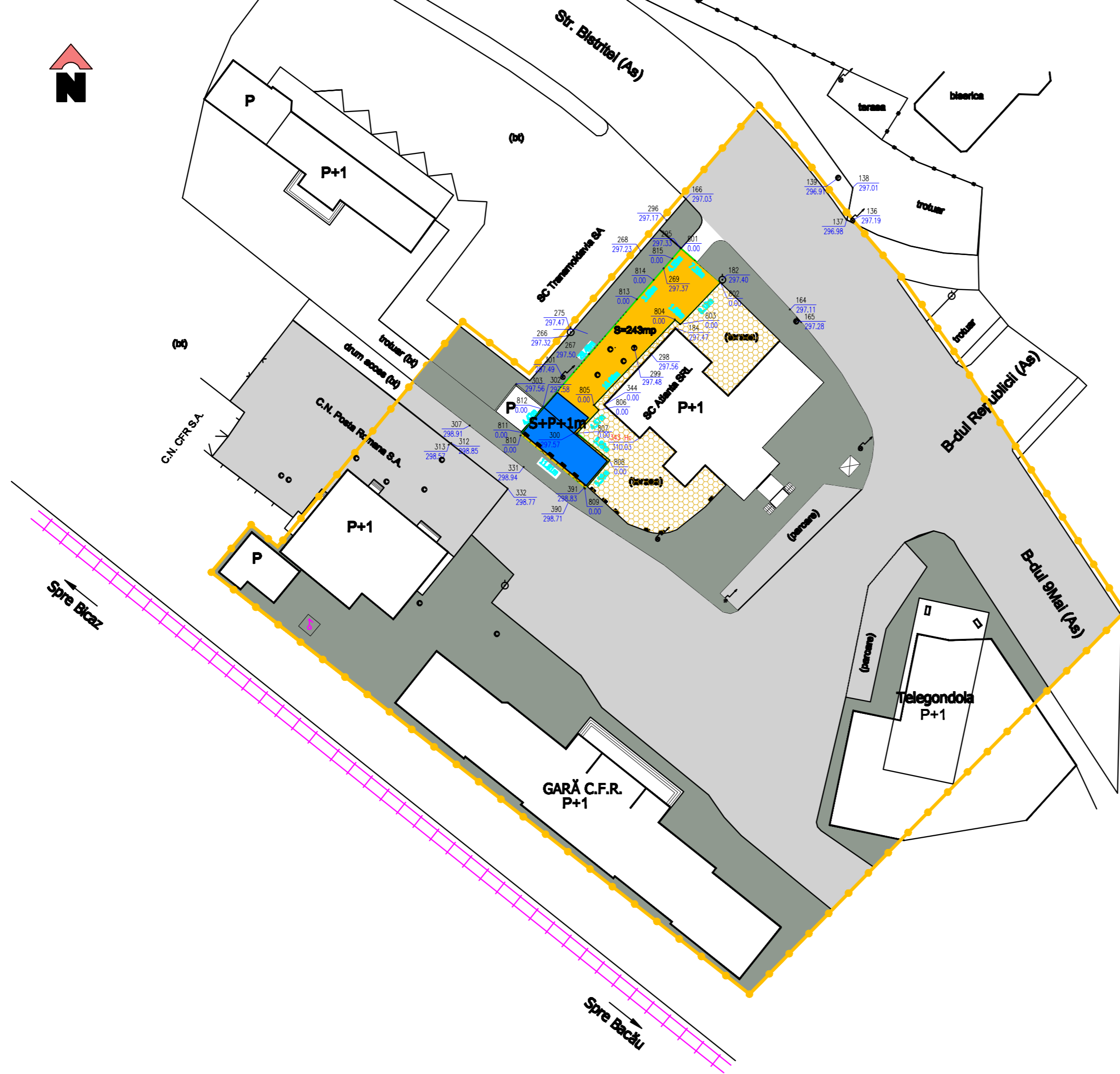







# P.U.Z. EXTINDERE SI ETAJARE BIROURI Str.Bistritei , Nr.3A , mun.Piatra Neamt

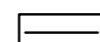

## LEGENDA :

-  LIMITA ZONA STUDIATA
-  TEREN PROPRIETATE DRAGHICEANU N.
-  DRUMURI, CAI DE ACCES, PARCARI
-  TROTUARE
-  CLADIRI EXISTENTE
-  OBIECTIV PROPUȘ PENTRU EXTINDERE SI ETAJARE (S+P+1m)
-  TERASE CLADIRI ALIMENTATIE PUBLICA
-  PAVAJ

Suprafata studiata  
S = 8032 mp

Verificator				
Expert				
VERIFICATORI EXPERT	NUME	SEMNATURA	CERINTA	REFERAT /EXPERTIZA NR/DATE
B.I.A. Arhitect ROPOTICA Înscris OAR - 62 din 15.04.2005 Piatra Neamt				Beneficiar: Drăghiceanu Neculai Str. Bistritei, nr. 3A, mun. Piatra Neamt
				Proiect nr. 10/2010
SPECIFICATIE	NUME	SEMNATURA	Scara	P.U.Z. EXTINDERE ȘI ETAJARE BIROURI Str. Bistritei, nr. 3A, mun. Piatra Neamt
Sef proiect	arh. T.Ropotica		1:500	FAZA P.U.Z.
Proiectat	arh. T.Ropotica			Planșa nr.
Desenat	ing. C. Ghiba		2010	REGLEMENTĂRI URBANISTICE
				2